

Bench table

PS16 V2

DESCRIPTION

SMART

- Precision horizontal measuring bench for the measurement of external dimensions
- Robust cast iron construction
- New design with integrated Bluetooth® system
- Large display resolution 0.0001 mm (0.1 µm) with tolerance status indication by colour LEDs
- Three buttons, including the central button with selectable favourite function
- 2 ergonomic, position-adjustable levers for moving the movable axis with ball bearing guide
- The position of the levers can be used to adjust the backward movement of the mobile axis.
- Compatible with Sylvac Ø 1.5 mm and Cary type anvils
- Supplied with hard metal measuring anvils Ø 1.5 mm
- Adjustable measuring force 0.1-0.6 N
- Measuring range 25 and 50 mm
- Additional data outputs Power and Proximity
- Protection class IP67

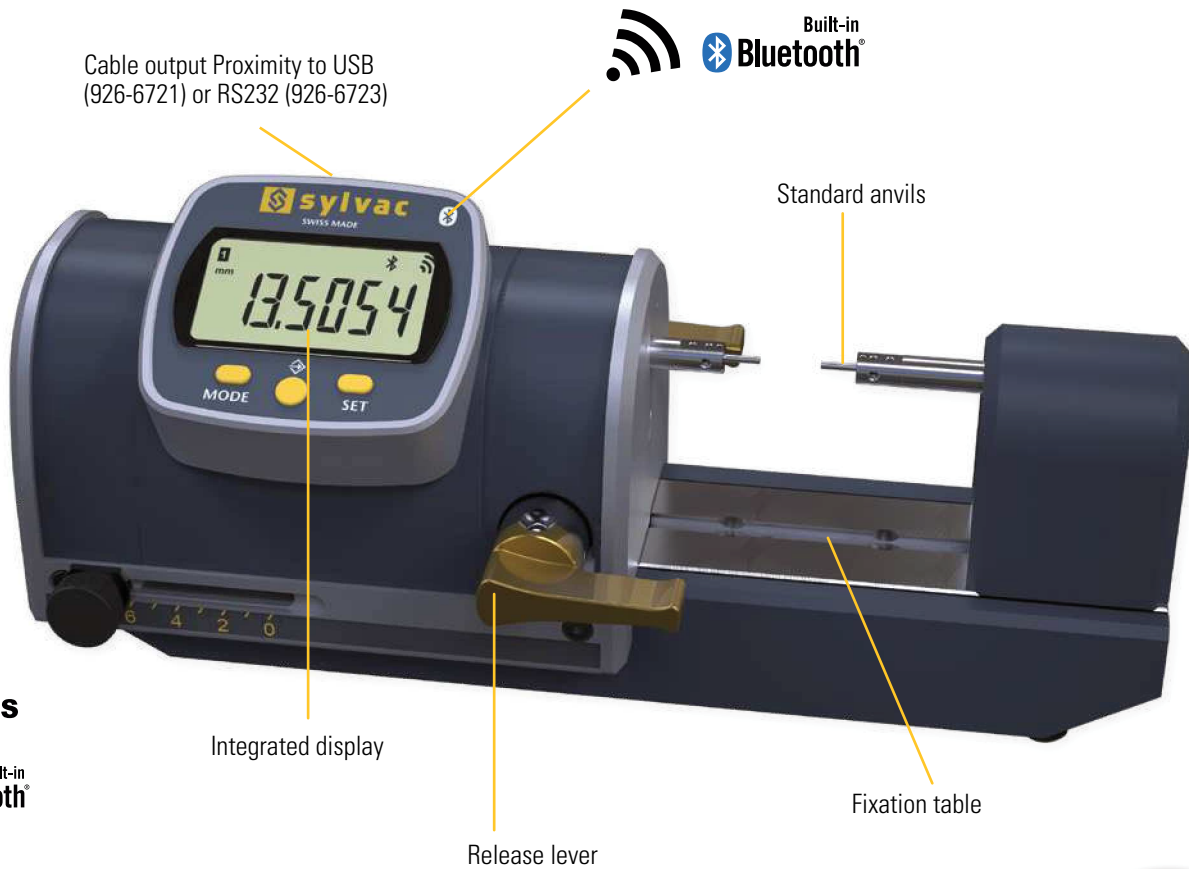

SWISS MADE

Built-in **Bluetooth**

USB

PROXIMITY

WATER RESISTANT

IP67

Cable output mini-USB to USB (926-6001)



Bench table

PS16 V2

DIMENSIONAL DRAWINGS

SMART

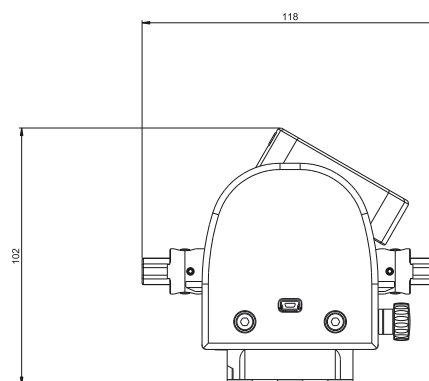
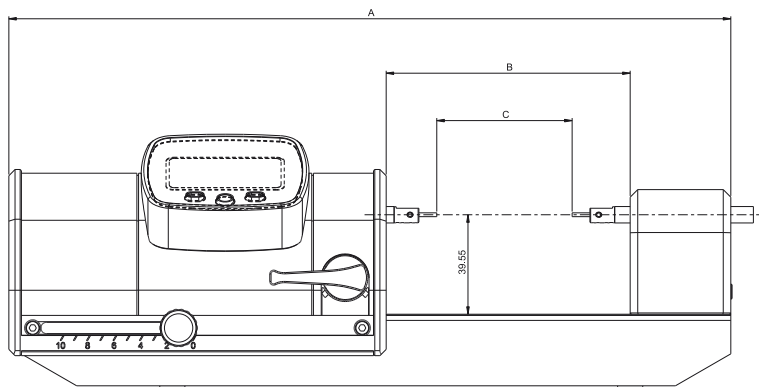

TECHNICAL SPECIFICATIONS

| External measurement | | 808-1231 | 808-1232 |
|------------------------------|----|---|----------|
| Max. Capacity C | mm | 25 | 50 |
| Max. Error | µm | 1.5 | 2.0 |
| Repeatability | µm | 0.2 | 0.2 |
| Resolution | µm | 0.1 | 0.1 |
| Measuring force (Adjustable) | N | 0.1 - 0.6 ¹⁾ | |
| Weight | kg | 3.6 | 4.2 |
| Output data | | Bluetooth® wireless technology* / RS232 / USB | |
| Anvils clamping dimension | mm | Ø 1.5 | |
| Cary compatibility | | ● | |
| A | mm | 232 | 287 |
| B | mm | 66 | 97 |

¹⁾ ± 20%

STANDARD DELIVERY

- Instrument according to technical specifications
- Instruction manual
- Lithium battery CR2477 included
- Adapter for Lithium battery CR2032
- Calibration certificate
- Table not included
- Anvils Ø 1.5mm (908-2175)
- Dust cover

Bench table

PS16 V2

TABLES, PLATES AND LAPPING



| N° | Designation | PS16 V2 25 | PS16 V2 50 | PS16 V2 LV | 3 points | Goutte |
|----------|--------------------------------|------------|------------|------------|----------|--------|
| 808-2190 | Supporting table XYZ | • | • | | | |
| 808-2302 | Supporting table adjustable XZ | • | • | | | |

ACCESSORIES



| N° | Designation | PS16 V2 25 | PS16 V2 50 | PS16 V2 LV | 3 points | Goutte |
|----------|---|------------|------------|------------|----------|--------|
| 908-2194 | Digital indicator holder (display height / depth) | | | • | | |
| 908-2198 | Replacement lapping stone for 908-2199 | • | • | | | • |
| 908-2199 | Lapping device (3 stones and lapping liquid included) | • | • | | | • |
| 808-2196 | Setting ring Ø20mm | | | • | | |
| 808-2197 | Setting ring Ø30mm | | | • | | |

Lapping device

- Device for lapping the anvils on the PS15 BH, PS16 V2 and PS17 measuring benches, enabling perfect parallelism of the anvils for greater measuring accuracy.
- Set consisting of a movable element with linear guide and a motorised rotary drive system for the honing stone
- Delivered complete with 3 honing stones and a bottle of honing liquid.

ANVILS

Compatible anvils list at the end of this chapter.