

Standard Cylinder Gauges

JIS B 7515

CC series

Peacock offers a complete line of Dial Bore Gauges with interchangeable anvils and necessary accessories to perform close tolerance measurements of holes, taper and roundness.

- Dial gauge mounting knob is very simple of and sure avoiding demerit of collet-system.
- The contact point is tungsten carbide ball.
- The standard ball tipped at the replacement rod is made of steel. The sintered hard-alloy ball is also available to tip.
- Wide range accuracy.....5 μm or less
- Adjacent error.....2 μm or less
- Repeated accuracy.....2 μm or less
- Effective measuring range is 0.5 mm (CC-02 CC-01)
- Effective measuring range is 1.2 mm (CC-1 to CC-6)



CC-2 head details

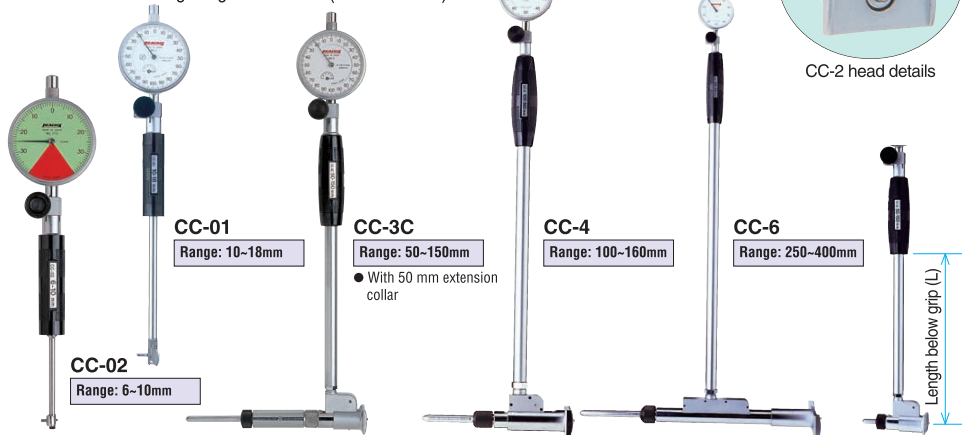

Specifications

Model	Range (mm)	Length below grip (mm)	Number of Feelers (mm)	Thickness of Washers (mm)
CC-02	6 ~ 10	50	Intervals 0.5 mm x 9	—
CC-01	10 ~ 18	100	Intervals 1 mm x 9	0.5 mm
CC-1	18 ~ 35	150	Intervals 2 mm x 9	0.5, 1 mm each
CC-2	35 ~ 60	150	Intervals 5 mm x 6	1,2,3 mm each
CC-3	50 ~ 100	150	Intervals 5 mm x 11	1,2,3 mm each
CC-3C	50 ~ 150	150	Intervals 5 mm x 11	1,2,3 mm each
CC-4	100~160	250	Intervals 10 mm x 7	1,2,3,4 mm each
CC-5	160~250	250	Intervals 10 mm x 10	1,2,3,4 mm each
CC-6	250~400	400	Intervals 10 mm x 16	1,2,3,4 mm each



CC-2 complete set

*Dial gauge is not furnished and supplied only on request. Suitable dial gauges are 17Z, 57B (0.01mm) and 15Z, 5F (0.001mm).

● List of special length below grip (available on request)

	L=50 (mm)	L=100 (mm)	L=200 (mm)	L=300 (mm)	L=400 (mm)	L=500 (mm)	L=600 (mm)	L=700 (mm)	L=800 (mm)	L=900 (mm)	L=1000 (mm)	L=1500 (mm)	L=2000 (mm)
CC-01	● standard	●	●	●	—	—	—	—	—	—	—	—	—
CC-1	● CC-1S	●	●	●	●	●	—	—	—	—	—	—	—
CC-2	● CC-2S	●	●	●	●	●	●	●	●	●	●	●	●
CC-3	● CC-3S	●	●	●	●	●	●	●	●	●	●	●	●
CC-3C	● CC-3CS	●	●	●	●	●	●	●	●	●	●	●	●
CC-4	●	●	●	●	●	●	●	●	●	●	●	●	●
CC-5	●	●	●	●	●	●	●	●	●	●	●	●	●
CC-6	●	●	●	●	● standard	●	●	●	●	●	●	●	●

● More than L=600mm for CC-2 can not measure from 35 to 44mm and can measure from 45 to 60mm ID.

Short Size Cylinder Gauges

S series

This is a compact cylinder gauge with a length below grip of 50 mm. It is used when a standard item is too long to measure the object or a shorter length of below grip is required for conveniently. Specifications are same as standard model.

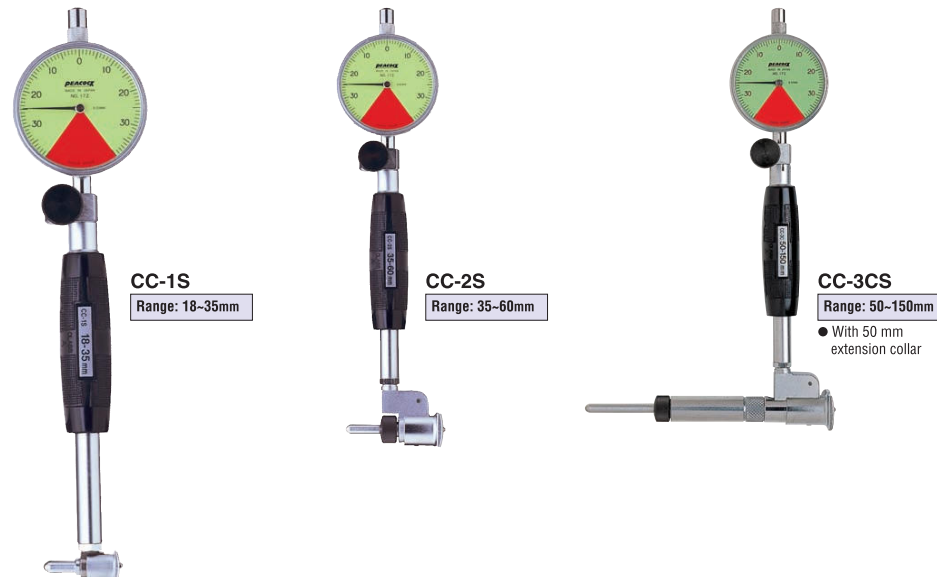

Outer Dimension

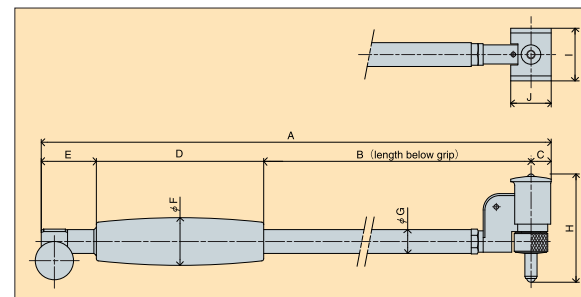

Dimension

Model	A	B	C	D	E	F	G	H	I	J
CC-1	249	150	5.75	70	23	20	10	18-35	13	11.5
CC-2	251.5	150	8.5	70	23	20	10	35-60	22	17
CC-3	253	150	9	70	23	20	10	50-100	30	18
CC-3C	253	150	9	70	23	20	10	50-150	30	18
CC-4	370	250	12	85	23	25	13	100-160	50	24
CC-5	391.5	251.5	14	100	26	25	16	160-250	70	28
CC-6	540	400	14	100	26	25	16	250-400	100	28
CC-1S	150	50	5.75	70	23	20	10	18-35	13	11.5
CC-2S	151.5	50	8.5	70	23	20	10	35-60	22	17
CC-3S	152	50	9	70	23	20	10	50-100	30	18
CC-3CS	152	50	9	70	23	20	10	50-150	30	18



Standard Cylinder Gauges



Short Size Cylinder Gauges

Cylinder Gauges (Blind Hole Type)

CG series

If using a CC type cylinder gauge for blind hole bore diameter, its guide plate interrupt the measurement at a point deeper than "T", as shown in the figure below.

In such case, the CG type with modified guide plate is suitable for measurement of the diameter to the point as deep as "t".

- Wide range accuracy...5 μm or less
- Adjacent error...2 μm or less
- Repeated accuracy...2 μm or less
- Effective measuring range is 0.5 mm (CG-01)
- Effective measuring range is 1.2 mm (CG-1 to CG-6)

Applied Example

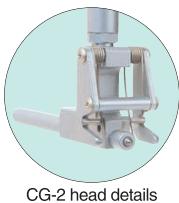
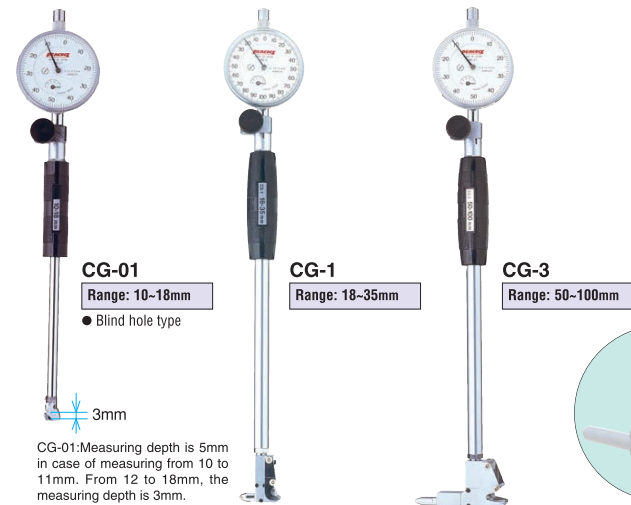
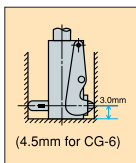
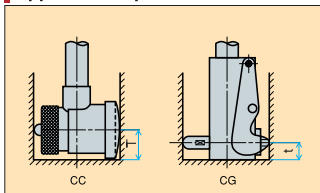

Specifications

Model	Range (mm)	Length below grip (mm)	Number of Feelers (mm)	Thickness of Washers (mm)
CG-01	10 ~ 18	100	Intervals 1 mm x 9	0.5 mm each
CG-1	18 ~ 35	150	Intervals 2 mm x 9	0.5, 1 mm each
CG-2	35 ~ 60	150	Intervals 5 mm x 6	0.5, 1, 2, 3 mm each
CG-3	50 ~ 100	150	Intervals 5 mm x 11	0.5, 1, 2, 3 mm each
CG-3C	50 ~ 150	150	Intervals 5 mm x 11	0.5, 1, 2, 3 mm each
CG-4	100 ~ 160	250	Intervals 10 mm x 7	1, 2, 3, 4 mm each
CG-5	160 ~ 250	250	Intervals 10 mm x 10	1, 2, 3, 4 mm each
CG-6	250 ~ 400	400	Intervals 10 mm x 16	1, 2, 3, 4 mm each

- * Dial gauge is not furnished and supplied only on request. Suitable dial gauges are 17Z, 57B (0.01mm) and 15Z, 5F (0.001mm).
- * CG-3C includes 50 mm extension collar.
- * In general, it is the range from the origin, that is the position where the plunger is pushed in by 0.1 mm, to the position where the plunger is pushed in further by 1.2 mm.

● List of special length below grip (available on request)

	L=50 (mm)	L=100 (mm)	L=150 (mm)	L=200 (mm)	L=250 (mm)	L=300 (mm)	L=400 (mm)	L=500 (mm)	L=600 (mm)	L=700 (mm)	L=800 (mm)	L=900 (mm)	L=1000 (mm)
CG-01	●	standard	●	●	●	●							
CG-1	●	●	standard	●	●	●	●	●					
CG-2	●	●	standard	●	●	●	●	●	●	●	●	●	●
CG-3	●	●	standard	●	●	●	●	●	●	●	●	●	●
CG-3C	●	●	standard	●	●	●	●	●	●	●	●	●	●
CG-4	●	●	●	●	standard	●	●	●	●	●	●	●	●
CG-5	●	●	●	●	standard	●	●	●	●	●	●	●	●
CG-6	●	●	●	●	●	standard	●	●	●	●	●	●	●

Dimensions for Feeler and Washer for Cylinder Gauges

CC-1 Feeler

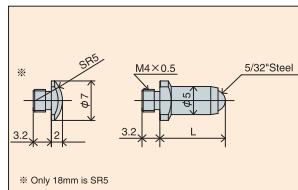

* Only 18mm is SR5

Model	Size (mm)	L (mm)
CC-1 Feeler	18	2
	20	4
	22	6
	24	8
	26	10
	28	12
	30	14
	32	16
	34	18

CC-2 Feeler

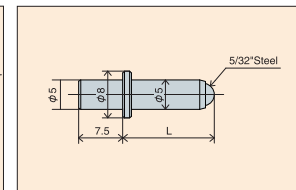

Model	Size (mm)	L (mm)
CC-2 Feeler	35	5
	40	10
	45	15
	50	20
	55	25
60	30	

CC-3·3C Feeler

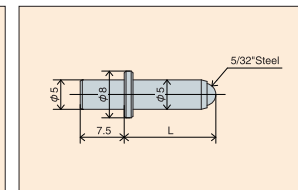

Model	Size (mm)	L (mm)
CC-3·3C Feeler	50	5
	55	10
	60	15
	65	20
	70	25
	75	30
	80	35
	85	40
	90	45
	100	55

CC-4 Feeler

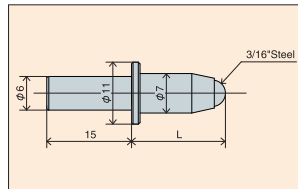

Model	Size (mm)	L (mm)
CC-4 Feeler	100	10
	110	20
	120	30
	130	40
	140	50
	150	60
160	70	

CC-5 Feeler

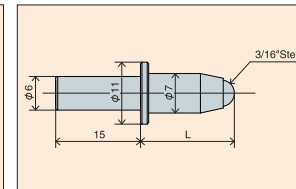

Model	Size (mm)	L (mm)
CC-5 Feeler	160	10
	170	20
	180	30
	190	40
	200	50
	210	60
	220	70
	230	80
	240	90
	250	100

CC-6 Feeler

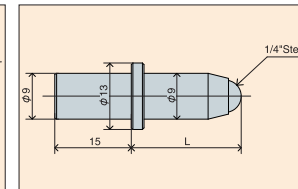

Model	Size (mm)	L (mm)
CC-6 Feeler	250	10
	260	20
	270	30
	280	40
	290	50
	300	60
	310	70
	320	80
	330	90
	340	100
	350	110
	360	120
	370	130
	380	140
390	150	
400	160	

CC-1~6 Washer

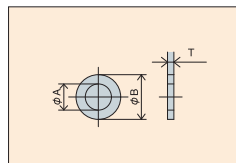

Model	T (mm)	A (mm)	B (mm)
CC-1	0.5, 1	4.1	7
CC-2	1, 2, 3	5.1	8
CC-3·3C	1, 2, 3	5.1	8
CC-4	1, 2, 3, 4	6.1	10
CC-5	1, 2, 3, 4	6.1	10
CC-6	1, 2, 3, 4	9.1	13



Cylinder Gauges

CC·CG-R series

Do you have any trouble when measuring internal diameter?
If so, we offer more radii of Contact Point & Feeler for Cylinder Gauges "R" Series.

- Wide range accuracy...5 μm or less
- Adjacent error.....2 μm or less
- Repeated accuracy.....2 μm or less

CC-1R



CC-3R



Specifications for CC-"R" series

Model	Range	Length below grip	Number of feelers	Thickness of washers	Extension collar
CC-01R	10~ 18mm	100mm	Intervals 0.5mm× 9	0.5mm	---
CC-1R	18~ 35mm	150mm	Intervals 2mm× 9	0.5, 1mm each	---
CC-2R	35~ 60mm	150mm	Intervals 5mm× 6	1, 2, 3mm each	---
CC-3R	50~100mm	150mm	Intervals 5mm×11	1, 2, 3mm each	---
CC-3CR	50~150mm	150mm	Intervals 5mm×11	1, 2, 3mm each	50mm

Specifications for CG-"R" series

Model	Range	Length below grip	Number of feelers	Thickness of washers	Extension collar
CG-01R	10~ 18mm	100mm	Intervals 0.5mm× 9	0.5mm	---
CG-1R	18~ 35mm	150mm	Intervals 2mm× 9	0.5, 1mm each	---
CG-2R	35~ 60mm	150mm	Intervals 5mm× 6	0.5, 1, 2, 3mm each	---
CG-3R	50~100mm	150mm	Intervals 5mm×11	0.5, 1, 2, 3mm each	---
CG-3CR	50~150mm	150mm	Intervals 5mm×11	0.5, 1, 2, 3mm each	50mm

Note: CG-01, in case 10~11mm measurement, the measuring depth is 5mm but 11~18mm is 3mm measuring depth.

Contact Point Hv700±50 (Tip heat treatment and hardened)

CC-01R
CG-01R

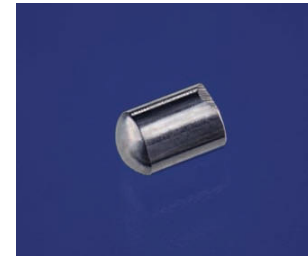

CC-1R · CG-1R · CG-2R
CG-3R · CG-3CR



CC-2R · CC-3R
CC-3CR



Feeler Hv700±50 (Tip heat treatment and hardened)

CC-01R
CG-01R



CC-1R



CC-2R · CC-3R
CC-3CR



Feeler Hv700±50 (Tip heat treatment and hardened)

CG-1R



CG-2R · CG-3R
CG-3CR



"R" Series Cylinder Gauges can be made Special Production as following:

- 1 Long Size of Length below grip Cylinder Gauge
- 2 Short Size of Length below grip Cylinder Gauge
- 3 Short Size of the overall length Cylinder Gauge
- 4 L-shaped Cylinder Gauge

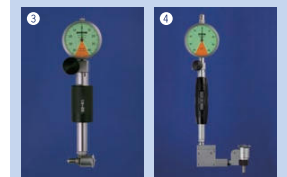

Dimensions for Feeler and Washer for R series Cylinder Gauges:

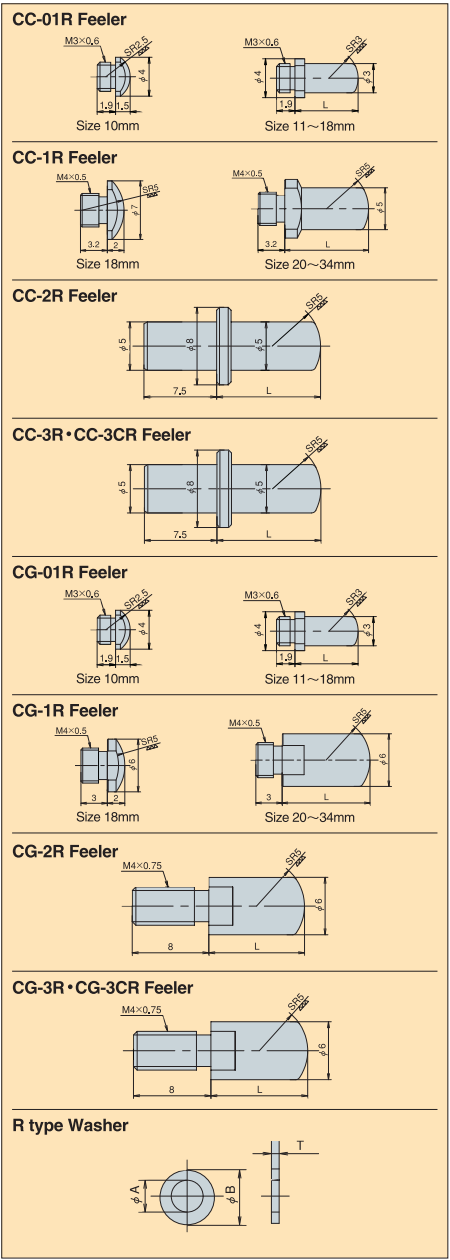

Size (mm)	L (mm)	Size (mm)	L (mm)
10	1.5	15	6.5
11	2.5	16	7.5
12	3.5	17	8.5
13	4.5	18	9.5
14	5.5		

Size (mm)	L (mm)	Size (mm)	L (mm)
18	2	28	12
20	4	30	14
22	6	32	16
24	8	34	18
26	10		

Size (mm)	L (mm)	Size (mm)	L (mm)
35	5	50	20
40	10	55	25
45	15	60	30

Size (mm)	L (mm)	Size (mm)	L (mm)
50	5	80	35
55	10	85	40
60	15	90	45
65	20	95	50
70	25	100	55
75	30		

Size (mm)	L (mm)	Size (mm)	L (mm)
10	1.5	15	6.5
11	2.5	16	7.5
12	3.5	17	8.5
13	4.5	18	9.5
14	5.5		

Size (mm)	L (mm)	Size (mm)	L (mm)
18	2	28	12
20	4	30	14
22	6	32	16
24	8	34	18
26	10		

Size (mm)	L (mm)	Size (mm)	L (mm)
35	5	50	20
40	10	55	25
45	15	60	30

Size (mm)	L (mm)	Size (mm)	L (mm)
50	5	80	35
55	10	85	40
60	15	90	45
65	20	95	50
70	25	100	55
75	30		

Model	T	A	B
CC01-R	0.5	3.1	4.5
CC-1R	0.5 · 1	4.1	7
CC-2R	1 · 2 · 3	5.1	8
CC-3R · CC-3CR	1 · 2 · 3	5.1	8
CG01-R	0.5	3.1	4.5
CG-1R	0.5 · 1	4.1	5
CG-2R	0.5 · 1 · 2 · 3	4.1	6
CG-3R · CG-3CR	0.5 · 1 · 2 · 3	4.1	6

Cylinder Gauges